

The use of this data by the recipient acts as an agreement of the following statements. Do not use this data if you do not agree with any of the following statements:-

All drawings are based upon site information supplied by third parties and as such their accuracy cannot be guaranteed. All features are approximate and subject to verification by a detailed topographical survey, statutory service enquiries and confirmation of the legal boundaries.

The controlled version of this drawing should be viewed in DWG or PDF format not DWG or other formats. All parts of this drawing must be made in full colour.

Use figured dimensions in all cases. Check all dimensions on site. Report any discrepancies in writing to CBS Consultants before proceeding.

KEY

— FOUJ DRAINAGE

— SURFACE WATER DRAINAGE

REFER TO DOCUMENT #9821- DRAINAGE STRATEGY & SUDS PLAN FOR DRAINAGE STRATEGY AND DESIGN DETAILS

ALL DRAINAGE TO BE INSTALLED IN LINE WITH APPROVED DOCUMENT - PART 11- DRAINAGE AND WASTE DISPOSAL

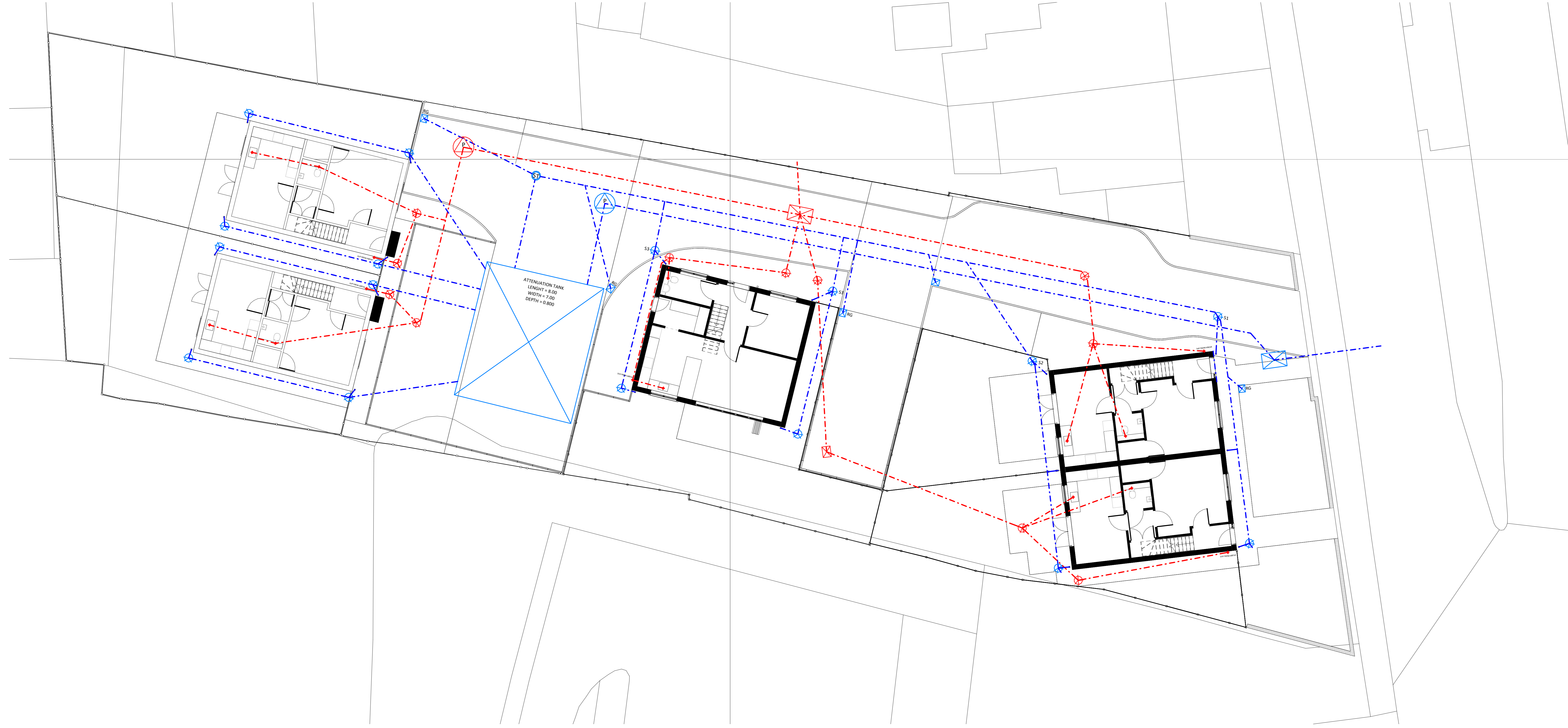

Proposed Site Drainage Plan
1 : 100

Revision	Date	Drawn by				
C01	19.01.2021	LS				
Construction						
Amendment						
Purpose of Issue						
Construction						
Project						
Virtue Property Group						
New Build						
102 Horley Road, RH1 5AA						
Drawing						
Proposed Site Information						
Proposed Site Drainage Plan						
Drawing No.	Designer	Zone	Level	Type	Role	Number
HOR11	CBS	ZZ	ZZ	DR	A	0020
CBS Project No.	Scale at A0	Drawn by	Status	Revision		
D_0154-	1 : 100	LS	A1	C01		